



the art of sound
ARTISON[®]

INSTALLATION GUIDE

Masterpiece LCR DualMono[®]
Portrait LCR DualMono[®]
Sketch LCR DualMono[®]

M-LCR-DM
P-LCR-DM
S-LCR-DM

CARTON CONTENTS:

- 2. LCR DM Speakers
- 2. Thin Universal Mounting Brackets
- 2. LCR DM Brackets
- 4. LCR DM Thumbscrews
- 4. LCR DM Extension Plates
- 1. Hardware Accessory Kit
 - 1. 2 meter, 16 ga. DualMono Jumper Speaker Wire
 - 1. 3mm Allen Wrench
 - 16. Bracket to Bracket (B to B) Screws, #10-32 x 7 mm
 - 4. Machine Screw, M4 x (13, 18 & 25) mm
 - 4. Machine Screw, M5 x (13, 18 & 25) mm
 - 4. Machine Screw, M6 x (13, 18 & 25) mm
 - 4. Machine Screw, M8 x (13, 18 & 25) mm
 - 4. Machine Screw, M10 x (13, 18 & 25) mm
 - 12. Flat Washer; 16 mm OD, 10 mm ID
 - 4. Flat Washer; 25 mm OD, 10 mm ID
 - 4. Flat Washer; 25 mm OD, 5 mm ID
 - 4. Collar Washer; 4.0mm ID, 10 mm OD, 6.5mm H
 - 4. Collar Washer; 5.0mm ID, 10 mm OD, 6.5mm H
 - 4. Collar Washer; 6.0mm ID, 10 mm OD, 6.5mm H
 - 4. Collar Washer; 8.0mm ID, 10 mm OD, 6.5mm H
- 8. Foam Dampeners
- 2. White Gloves
- 1. Installation Guide
- 1. Warranty Card

If you are missing any of these parts or if you need assistance during the installation of your Artison LCR DM's, please contact Artison's Customer Service Department during normal business hours, Pacific Time at (775) 833-4344.

Thank you for choosing the Artison LCR DualMono® Speakers. We are pleased that you have selected our high-performance audio products. The following information will guide you through the installation of your Artison LCR DualMono Speakers.

INTRODUCTION

Artison LCR DualMono (LCR DM) speakers are designed to attach directly to any Flat Panel TV (FPTV) with the included Thin Universal Mounting Bracket (Thin UMB) and come with custom made grilles specific to your FPTV. Artison's patented DualMono Center Channel design uses an array of two Center Channels, one Left Channel, and one Right Channel; all housed in two aluminum enclosures. All 4 speakers have independent air chambers and crossovers. The two enclosures are then covered with grilles specific to the FPTV height. This creates one sleek home theater solution attached directly to a thin FPTV.

The Thin UMB attaches to any FPTV using the VESA mounting points on the rear surface. Using the Thin UMB, the LCR DM speakers can be attached to any FPTV in a table top application or a wall-mount application in conjunction with any FPTV wall-mount bracket. The LCR DM speakers can also be separately wall-mounted using the included LCR DM Bracket.

G LCR DM Grilles are available customized to the height and bezel color of any Make and Model FPTV. Artison maintains a database of popular FPTV's and can match the exact height of any set. Any Artison Dealer can order a custom made grille pair for your FPTV.

G LCR DM Grilles used with Portrait LCR DM or Sketch LCR DM speakers are compatible with any FPTV that is 25.4" inches tall or larger. G LCR DM Grilles used with Masterpiece LCR DM speakers are compatible with any FPTV that is 30.0" inches tall or larger.

All LCR DM models are compatible with displays that are 7 mm – 111 mm, (0.28" – 4.4") in depth.

INSTALLATION OPTIONS

The Artison LCR DM Speakers were designed to have multiple installation options using the included hardware and brackets.

- Attachment to any Flat Panel TV (FPTV) in a Tablestand or Wall Mounted installation.
- On-Wall/Surface Mounting.

Please read the instructions below before attempting your installation.

INSTALLATION PROCEDURES

The Thin UMB was designed in compliance with the VESA Mounting Standards. When using a third party FPTV wall-mount, the Thin UMB's are placed between the FPTV chassis and the FPTV wall-mount. In cases where the display utilizes a table top stand, the Thin UMBs can be attached directly to the FPTV's chassis.

1. Components Needed for Installation:

1.1. Wall Mounted FPTV and LCR DM: Thin UMBs, Mounting Screws with Collar Washers and Third Party Wall-Mount Bracket.

1.2. Tabletop FPTV and LCR DM: Thin UMBs, and Mounting Screws with Collar Washers.

REMOVAL OF FPTV CURRENTLY INSTALLED

2. If your FPTV is currently wall mounted, disconnect any wiring connections and remove the FPTV from the wall mount. **NOTE: This step may require two or three people.**
3. Place FPTV in safe location, display side down on a soft non-abrasive surface.
4. Remove any existing mounting brackets and screws from the VESA mounting points on the rear of the FPTV.

THIN UMB PLACEMENT

5. Locate the Thin UMBs, loosen the 8 mm (5/16") Clamp Bolts on each end.
6. Extend the Slider Arms so that they are approximately the FPTV width. Do not tighten the clamp bolts yet.
7. Position one Thin UMB across the top mounting points, one Thin UMB across the bottom set of mounting points. Center the Thin UMBs horizontally on the display. This will ensure equal extension of the Slider Arms in both directions. **NOTE: If the Slider Arms do not extend far enough to reach both sides of the FPTV or if the FPTV's mounting points do not fit within Aluminum Main Bar's slot width, then your installation will require a Thin Long Main Bar (Thin LONG-MB).**

SLIDER ARM POSITION BASED ON FPTV THICKNESS

8. Depending on the FPTV depth the Slider Arm Position and use of LCR Extension Plates will vary. Refer to the following; **TABLE 1 and FIGURES 1-6**, to see how best to setup your Thin UMB.
9. If **TABLE 1** calls for the 'Backward' position. Remove the Slider Arm from the Aluminum Main Bar, rotate 180 degrees, and reinsert into the Aluminum Main Bar.

Figure	FPTV Thickness	Thin UMB Slider Arm Position	Screw Position	Extension Plate	Minimum TV Wall Mount Bracket Depth
1	0.28" – 1.0"	Backward	Back	No	1.54"
2	1.0" - 1.75"	Backward	Front	No	0.82"
3	1.5" - 2.25"	Forward	Back	No	0.32"
4	2.0" – 2.75"	Forward	Front	No	0
5	2.9" – 3.75"	Forward	Back	Yes	0
6	3.4" – 4.4"	Forward	Front	Yes	0

TABLE 1

ALIGNMENT OF THE SLIDER ARMS

10. Align the outer edge of each Slider Arm should be flush with the outside edge of the display's bezel. If you are using the Extension Plate align this surface with the display bezel. Refer to **FIGURES 1-6**.
11. Tighten the clamp nuts on the UMB using the 8 mm (5/16") wrench. This will align the LCR correctly so the Grille will be flush to the side of the FPTV.

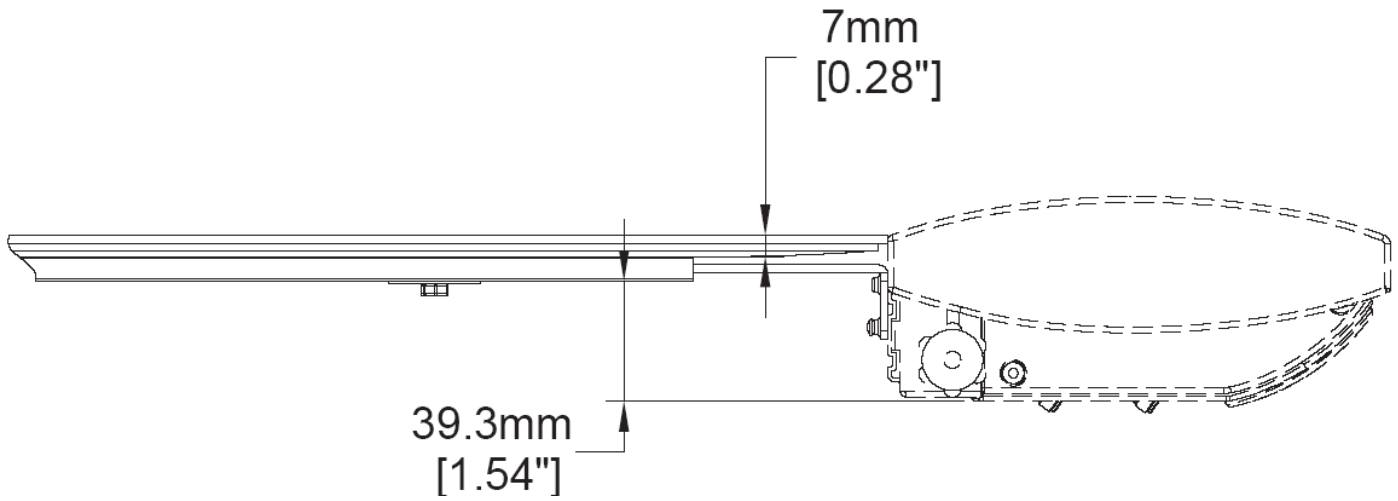

FIGURE 1

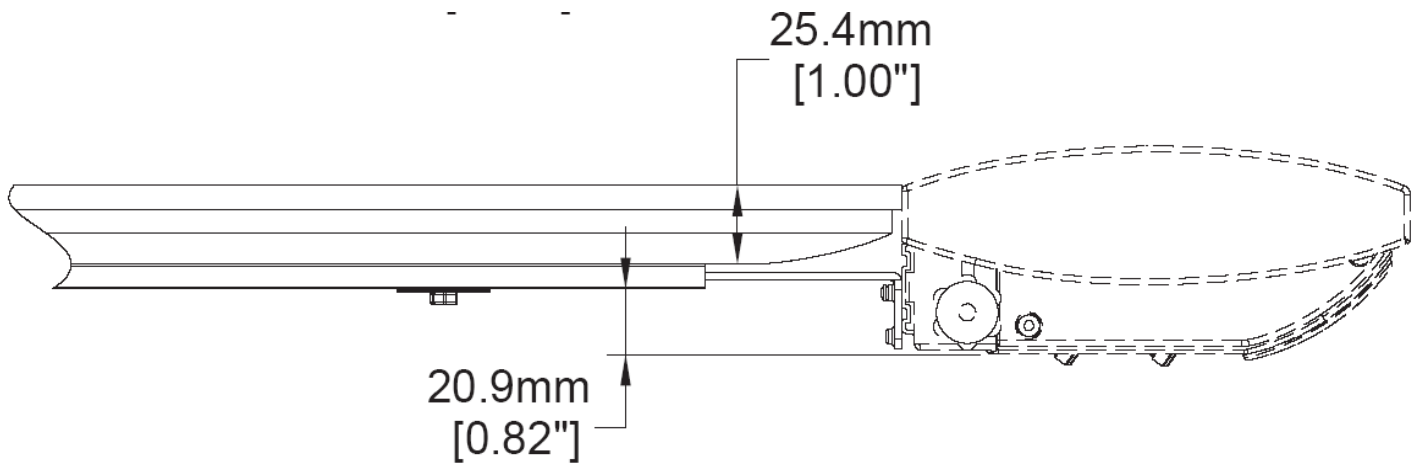

FIGURE 2

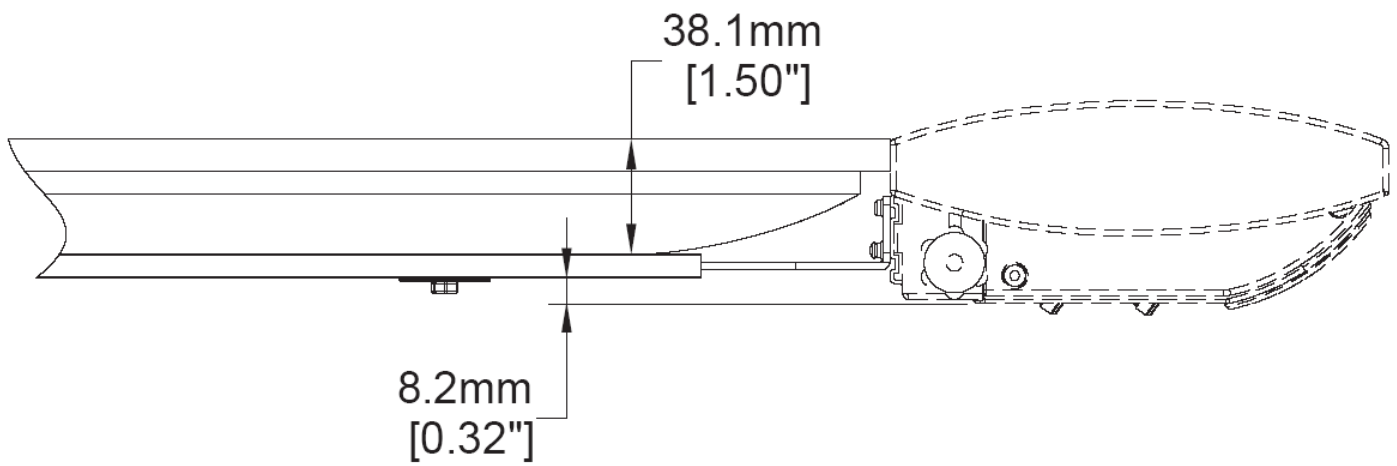

FIGURE 3

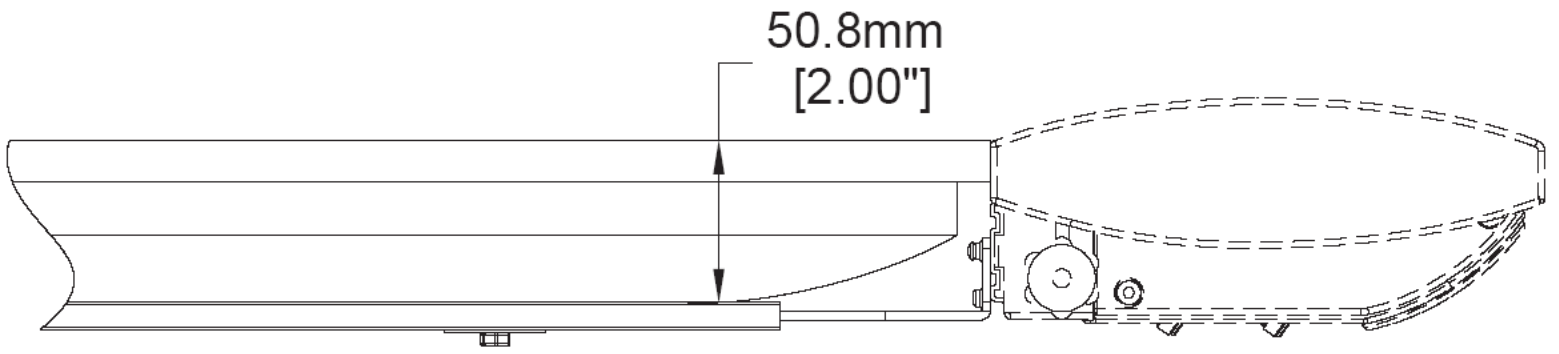

FIGURE 4

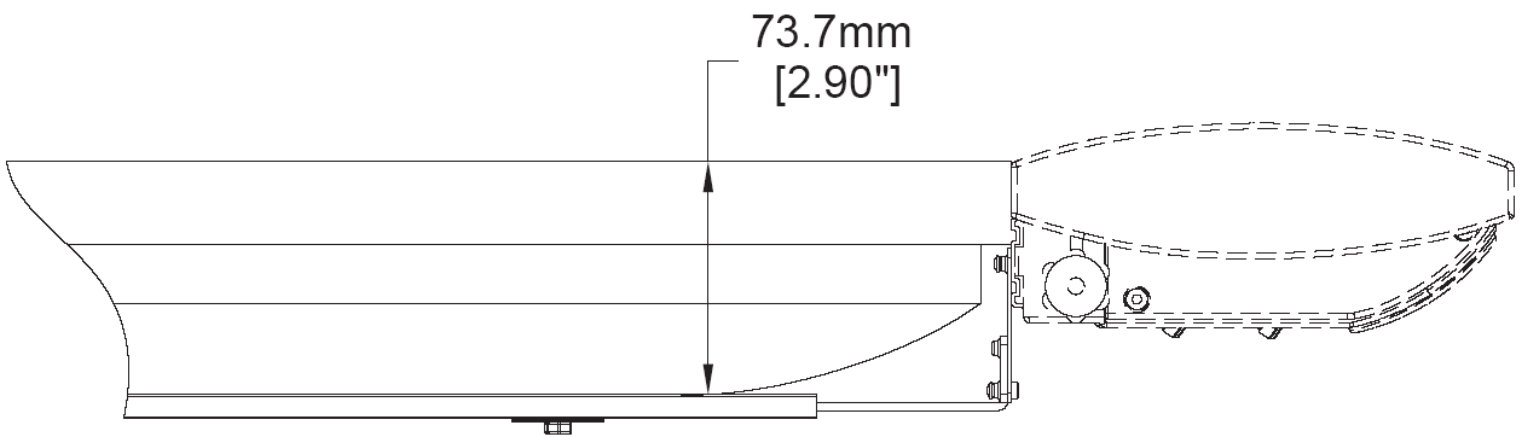

FIGURE 5

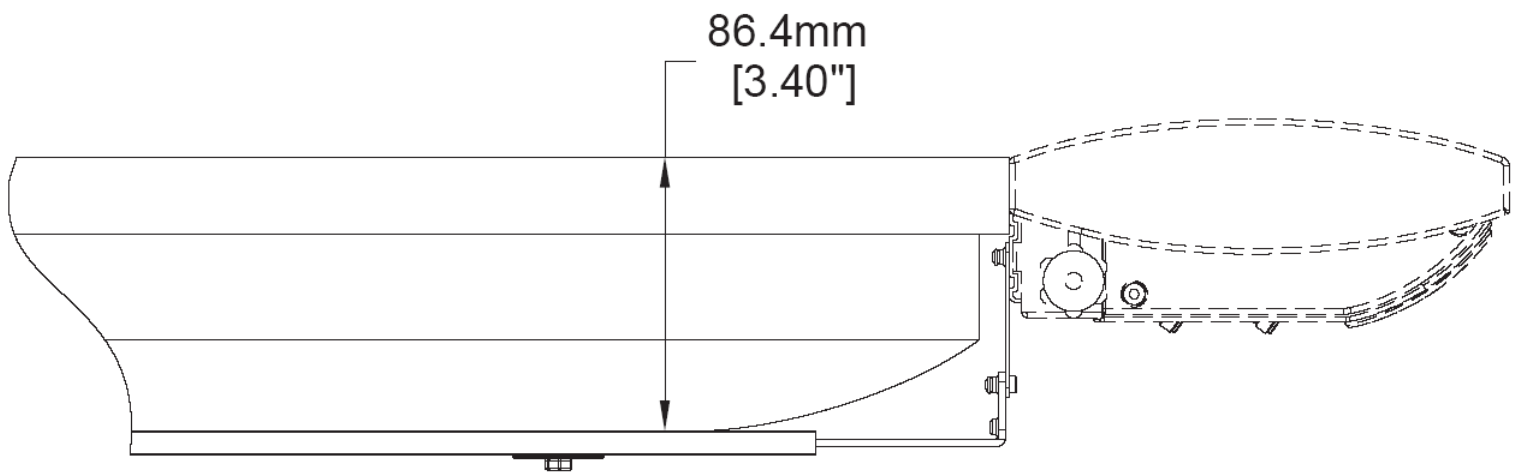
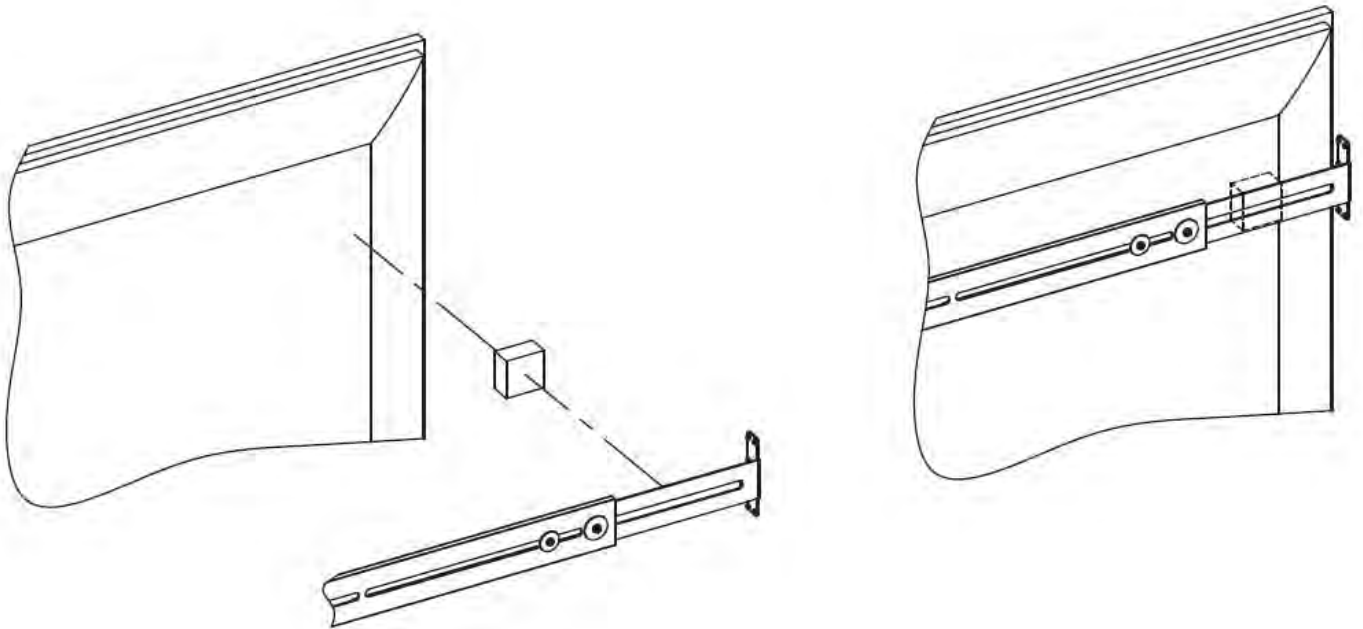

FIGURE 6

FOAM DAMPENERS

12. The foam provides both damping for the mounting system and stabilizes the speaker. The pads should be attached to the television surface behind the Slider Arm. The foam is intended to be highly compressed to fit under the Slider Arm.
13. Expose the adhesive backing by folding a small corner of the protective paper back on itself. Then unfold the paper and remove.
14. Place the 2" x 2" x 1" Foam Dampeners to the TV chassis directly underneath the Slider Arms close to the speaker. If there is a large gap between the Slider Arm and TV chassis two pads may be stacked on top of each other. **Refer to FIGURES 7 & 8.**



FIGURES 7 & 8

HARDWARE KIT

15. Mounting Screw Selection

15.1. Thread Pitch: M4, M5, M6, M8, or M10.

15.1.1. Match the threads in the FPTV chassis to one from the kit.

15.2. Screw Length: 13, 18 or 25 mm.

15.2.1. First, check the thread depth of the mounting points on the FPTV.

15.2.2. Select a length that will accommodate the Thin UMB (Depth = 7mm), third party wall-mount, and washers. Allow for 5 - 8 mm of screw threads into the FPTV chassis. Be sure to account for the maximum thread depth into the TV.

NOTE: For tablestand installations without additional mounting hardware, select the smallest length, 13 mm.

16. Collar Washers: M4, M5, M6 or M8.

16.1. The collar washer will fit snugly around your selected machine screw and fill the excess area in the slot of the Thin UMB. **NOTE: Collar washers are NOT needed for M10 screw.**

17. Flat Washer: Select a washer that fits around the selected Mounting Screw.

18. Using the selected components from Steps 1.1 & 1.2., refer to **FIGURES 9 & 10** to assemble the components to the FPTV chassis. **NOTE: Tighten all hardware securely.**

19. Attach the FPTV to the wall.

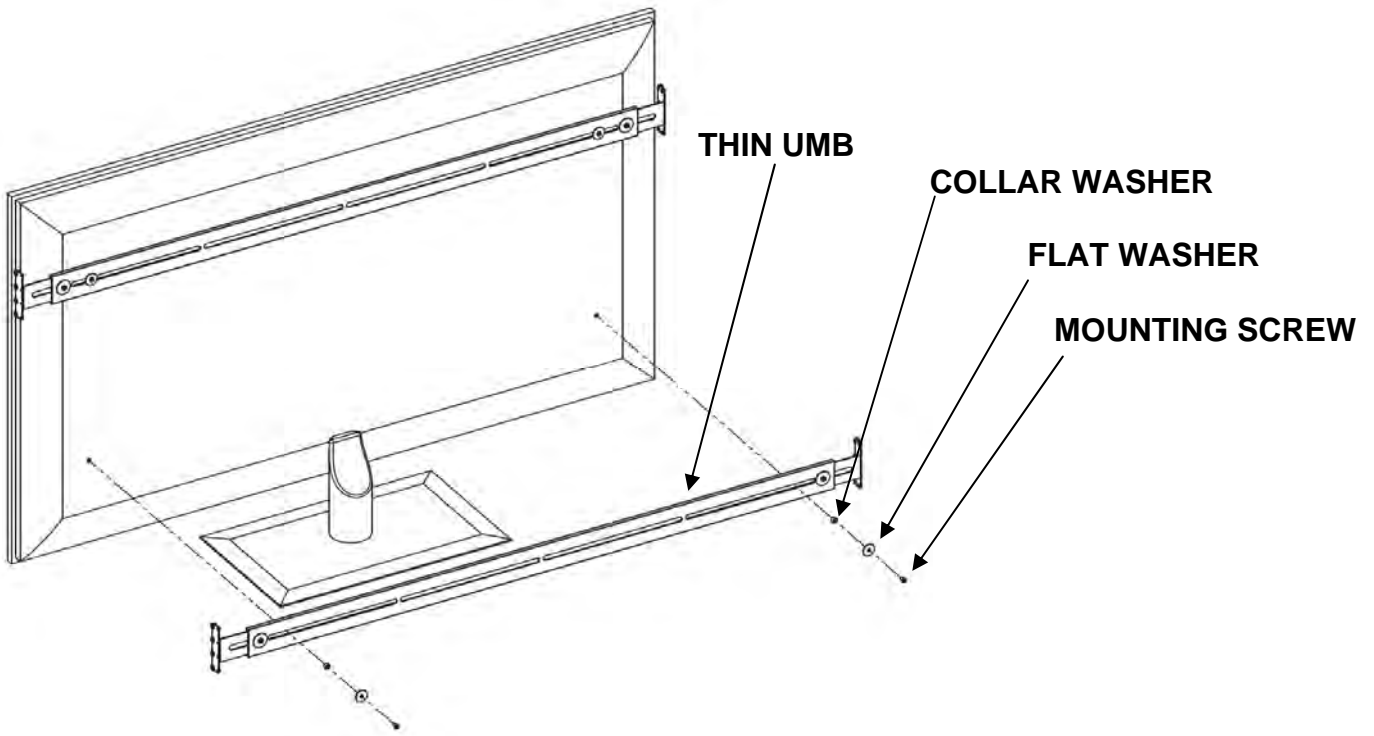

FIGURE 9

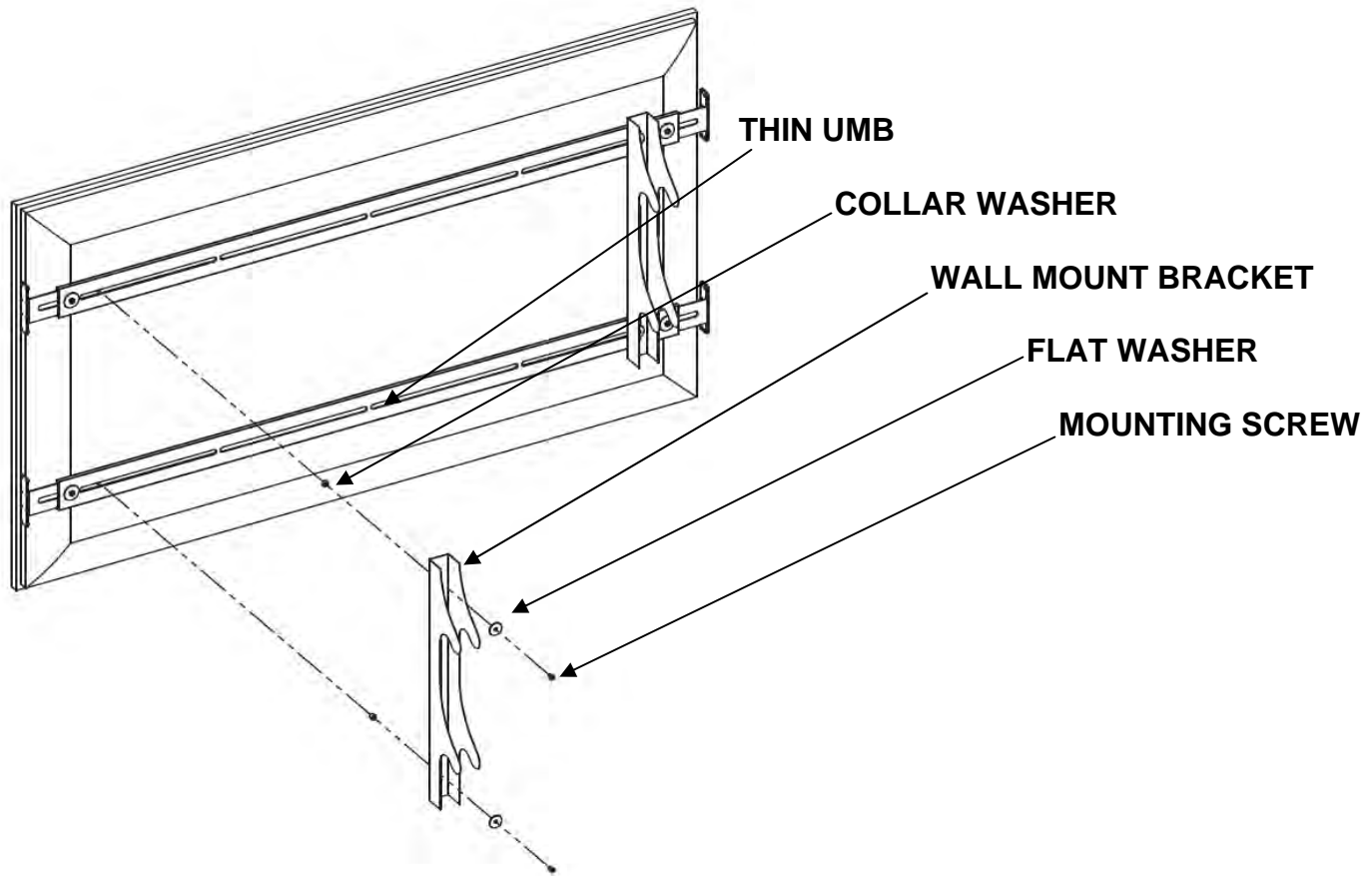

FIGURE 10

MOUNTING THE LCR DM BRACKET TO THE THIN UMB

20. Remove the LCR DM Bracket from the speakers by loosening the 2 thumbscrews in a counter-clockwise direction. **Refer to FIGURE 11.**
21. Carefully slip off the bracket. **NOTE: DO NOT place the LCR DM face down as this may permanently damage the drivers.**
22. Attach the LCR DM Brackets to the Slider Arms using the 3 mm Allen Head Bracket to Bracket (B/B) Screws. Refer to **TABLE 1** for the correct screw location.
23. Loosely attach using the B/B Screws to hold the LCR DM Brackets in place. Only 2 screws per slider arm are required.
24. Using a tape measure, vertically center the LCR DM Brackets by having equal distances from the ends of the bracket to the top and bottom of the FPTV edge. Then tighten the Bracket to Bracket Screws. **Refer to FIGURE 12.**

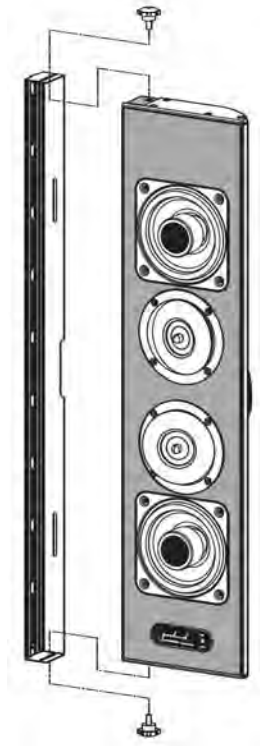

FIGURE 11

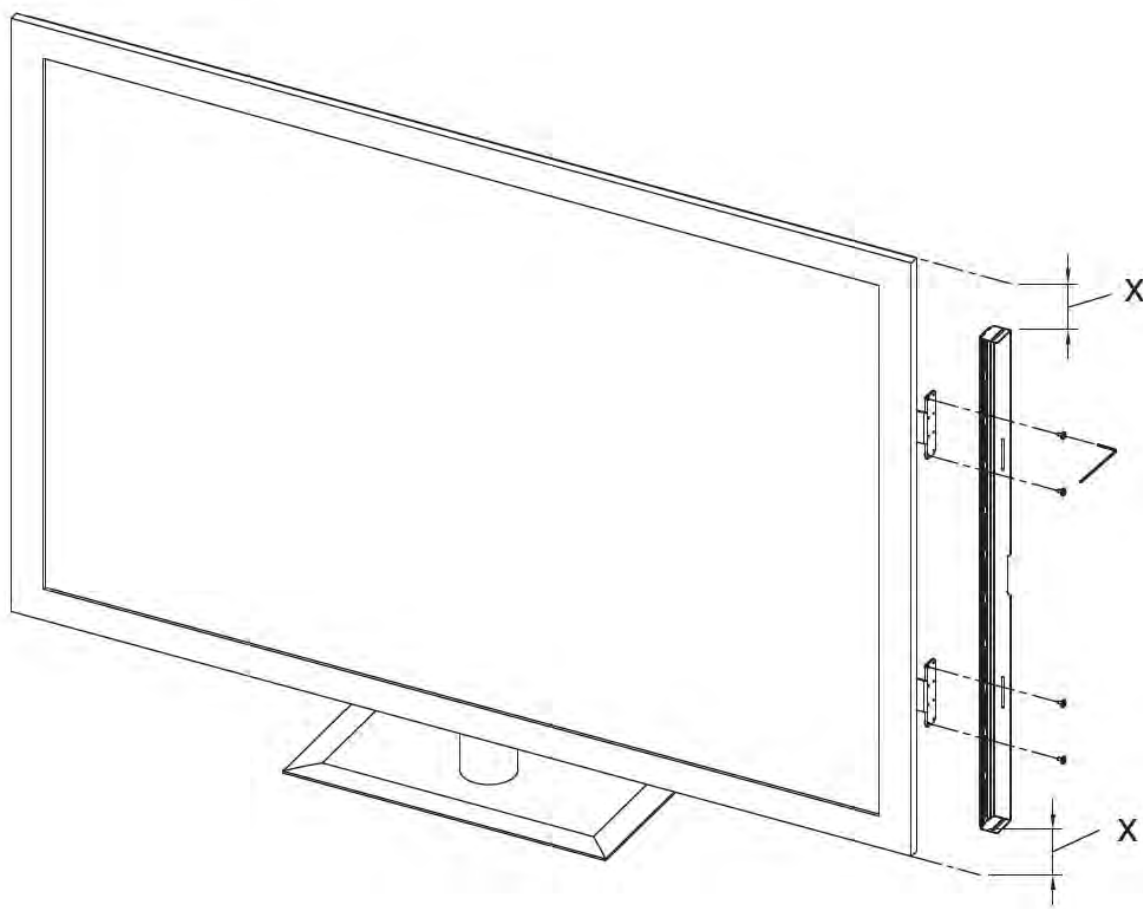

FIGURE 12

MOUNTING THE LCR DM SPEAKER INTO LCR DM BRACKET

25. Carefully slide the LCR DMs into the vertical bracket that is now mounted to the display. Place each speaker on their corresponding sides of the television. The DualMono Center Channels should be located on the top half of the display. **Refer to Figure 13.**
26. Using the thumbscrews loosely re-attach the speakers. Adjust the front to back speaker position using the slot until the front edge is approximately 1/4" behind the front surface of the bezel.
27. Tighten the thumbscrews to hold the speaker in place. **NOTE: It is best to perform final alignment of your speaker after wiring and grilles are installed.**

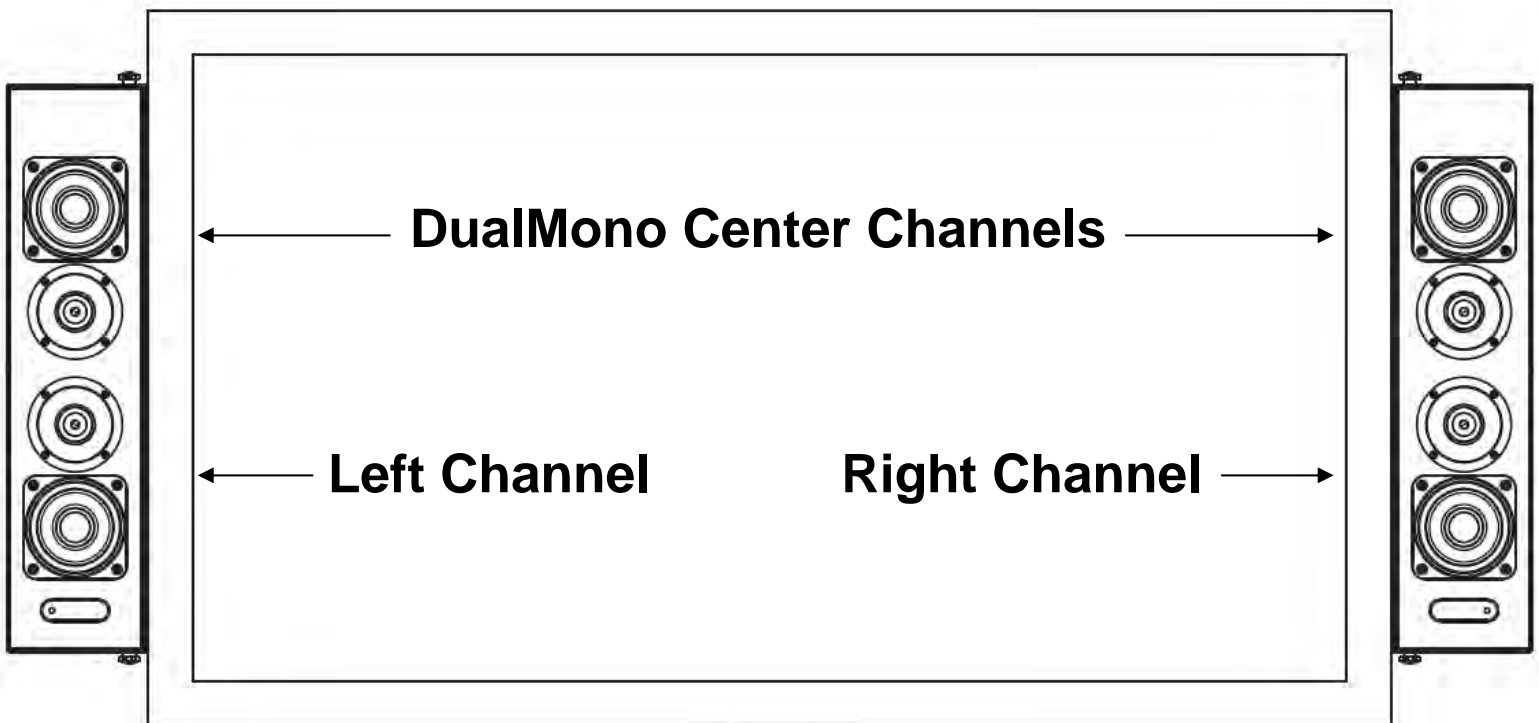

FIGURE 13

GRILLE INSTALLATION

- 28.** Grilles are held to the speaker by Hook and Loop fasteners, commonly known as Velcro[®]. All LCR DM Grilles have 2 large hook pads. The woofer motors have the Loop surface.
- 29.** Align the grille with the top and bottom edges of the FPTV, directly over the face of the speaker baffle.
- 30.** Press the grille firmly onto the woofer motor surfaces.
- 31.** The grille can be removed easily by simply pulling on the grille to separate the Velcro pads.
- 32.** Perform final adjustment to the speaker's front / back alignment using the thumbscrews. The grille edge should match the bezel height of the FPTV as shown in Figures 1-6.

ON-WALL INSTALLATION OF THE LCR DM

1. Remove the LCR DM Bracket from the speakers by loosening the 2 thumbscrews in a counter-clockwise direction.
2. Carefully slip off the bracket. **Refer to FIGURE 11. NOTE: DO NOT place the LCR face down as this may permanently damage the drivers.**
3. The LCR DM Brackets have two slots cut through the rear of the part which will function as a surface mount bracket. Refer to **FIGURE 14.**
4. Make a hole directly behind the terminal posts in the center of the speaker bracket for the speaker wire.
5. Place each LCR DM on their corresponding sides of the television. The DualMono Center Channels should be located on the top half of the display. **Refer to FIGURE 13.**

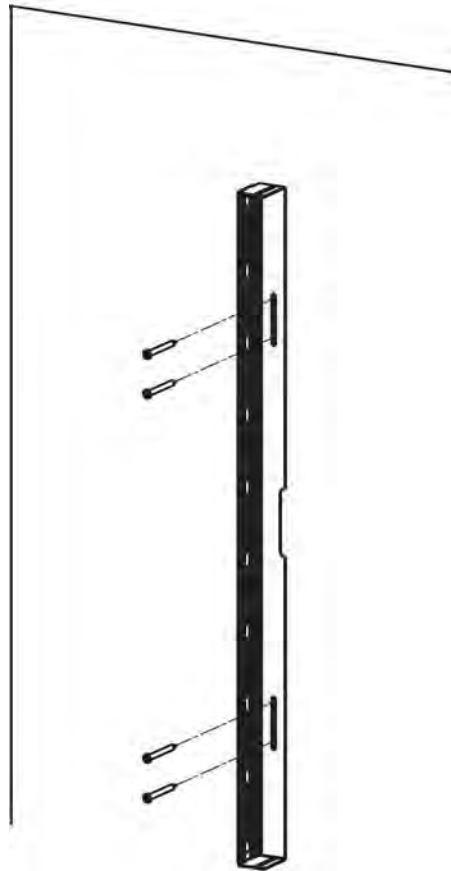

FIGURE 14

/

WIRING THE LCRS

3 CHANNEL METHOD (Left, DualMono Center and Right)

1. Operate the terminals by firmly pressing on them. An opening will be exposed in the side of the terminal. Slip about 9 mm (3/8") of bare speaker wire into this opening hole and release the terminal. The spring loaded terminal will now securely hold the wire in place. 16 gauge is the minimum requirement. Depending upon total wire length a larger gauge may be used. 12 gauge is the maximum that will fit into the terminals.
2. **Left and Right Channels**
 - 2.1. Connect two conductor speaker wire between each channel and the receiver or amplifier. Mind the polarity of the wiring is consistent. (+ to +, - to -)
3. **DualMono Center Channels**
 - 3.1. Using the supplied 2 meter speaker wire, connect both center channels together in parallel. This is done by connecting Red to Red and Black to Black, (+ to +, - to -).
 - 3.2. Connect two conductor speaker wire between one of the DualMono Center Channels and the receiver or amplifier. The wire from the amplifier and the wire from the opposite center channel should be twisted together and placed in the terminals. Mind the polarity of the wiring is consistent. (+ to +, - to -)
4. Refer to **FIGURE 15**.
5. **NOTE: This can be achieved by using 2 runs of 4 conductor speaker wire. One run per side of the FPTV. Separate the 4 conductors into 2 pairs. Connect one pair to each channel. The parallel connection of the DualMono Center Channels can be made at the amplifier.**

2 CHANNEL METHOD (Left/Right Stereo)

1. Using a single conductor of speaker wire, connect the negative terminal of the Left Channel to the positive terminal of the DualMono Center Channel in the same cabinet. This puts the two channels in series.
2. Similarly, connect a single conductor from the negative terminal of the Right Channel to the positive terminal of the DualMono Center Channel in the same cabinet.
3. Using two conductor speaker wire, connect the Left and Right channel outputs of the receiver or amplifier to the pair of unused + and - terminals on each corresponding side.
4. Refer to **FIGURE 16**.

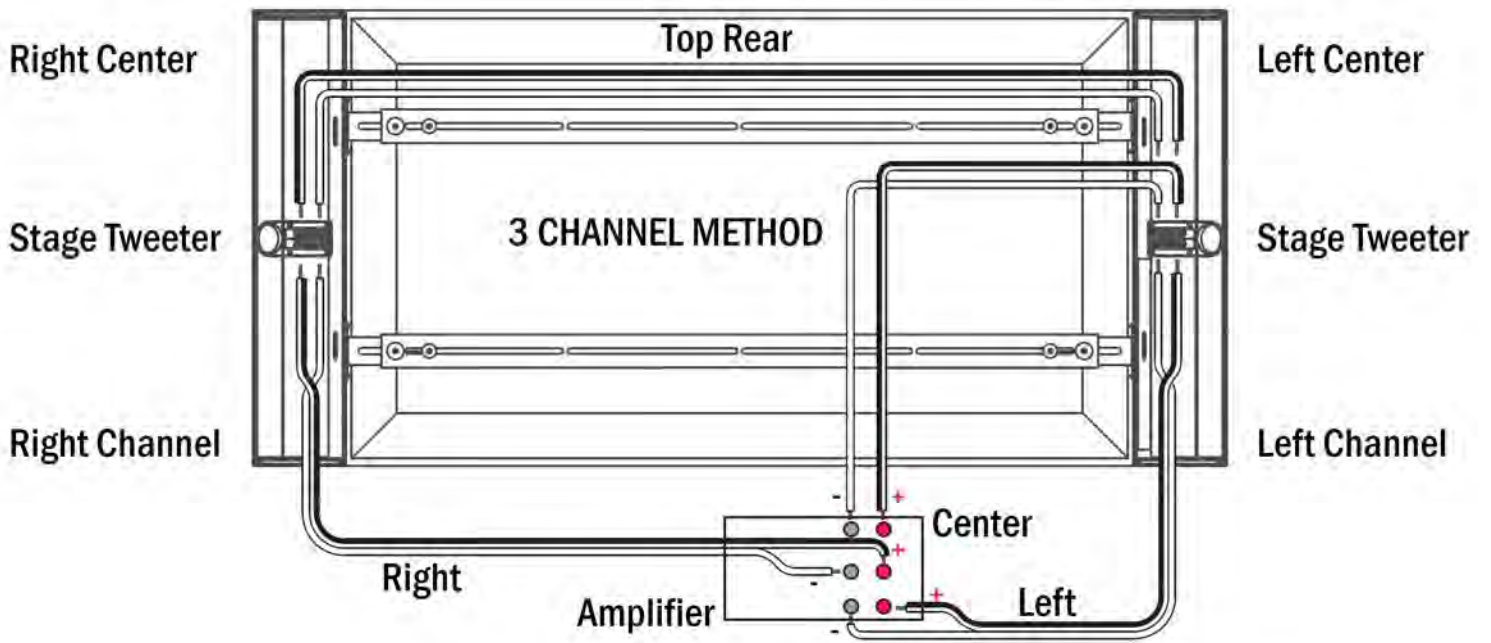

FIGURE 15

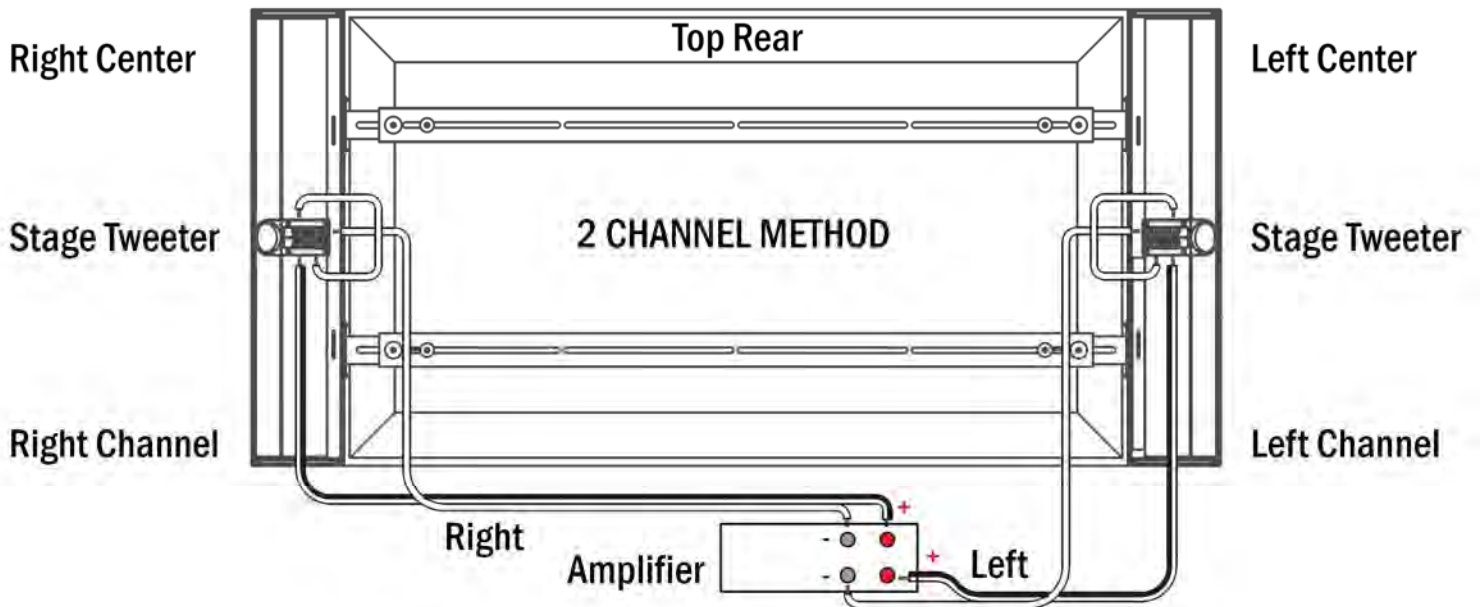

FIGURE 16

FINE TUNING YOUR LCR-DM SPEAKERS

Satellite / Subwoofer Crossover Frequencies:

P-LCR-DM & S-LCR-DM:

- 'SMALL' Speaker on A/V Receiver / Processor
- Crossover Frequency: 85 Hz
- Crossover Slope: 12 dB/octave

M-LCR-DM:

- 'SMALL' Speaker on A/V Receiver / Processor
- Crossover Frequency: 80 Hz
- Crossover Slope: 12 dB/Octave

Stage Tweeter ON / OFF Switch:

This located on the front baffle of each speaker below the Left/Right Channel Woofer.

- In most applications, the Stage Tweeter should be ON. The Stage Tweeter widens the Left & Right Channel separation by directing high frequency, 6 kHz and up, against the adjacent rear wall the flat panel is mounted onto.
- Turn the Stage Tweeter OFF for installations where the speakers and FPTV are flush mounted into recessed cabinetry.

Adjustable Tweeters:

The P-LCR-DM is equipped with adjustable front firing Vifa XT25 Tweeters.

- DualMono Center Channel Tweeters should both be aimed towards the center of your primary listening area.
- Left and Right Channel Tweeters should be aimed to the respective Left and Right sides of your primary listening area.

SPECIFICATIONS & DIMENSIONS:

Masterpiece LCR DualMono

M-LCR-DM

Dimensions:	29.6" x 6.3" x 2.4", HWD Overall 30.0" x 6.5" x 2.6", HWD w/ Minimum Grille Mounting Depth 2.1" ≤ (TV + Thin UMB + Wall Mount) For use with FPTV's 55" or larger: H ≥ 30.0", D 0.28" - 4.4"
Driver Complement:	2. 5½" Kevlar, Long Throw, Inverted Magnet, Midrange/Woofer 2. 8 x 1" ART Drivers in Curved Line Array 1. 25mm Stage Tweeter
Cabinet / Finish:	Extruded Aluminum / Black Anodized; Grille Cloth available in Black or Light Grey
Frequency Response:	80 Hz – 30 kHz ± 3 dB
Recommended Power:	125 - 250 Watts
Nominal Impedance:	6 Ω
Sensitivity:	86 dB @ 2.83 Volts, 1 Meter
Enclosure Type:	Acoustic Suspension
System Weight:	28 lbs. (13 kg.) incl. Speakers, Mounting Hardware & Grilles

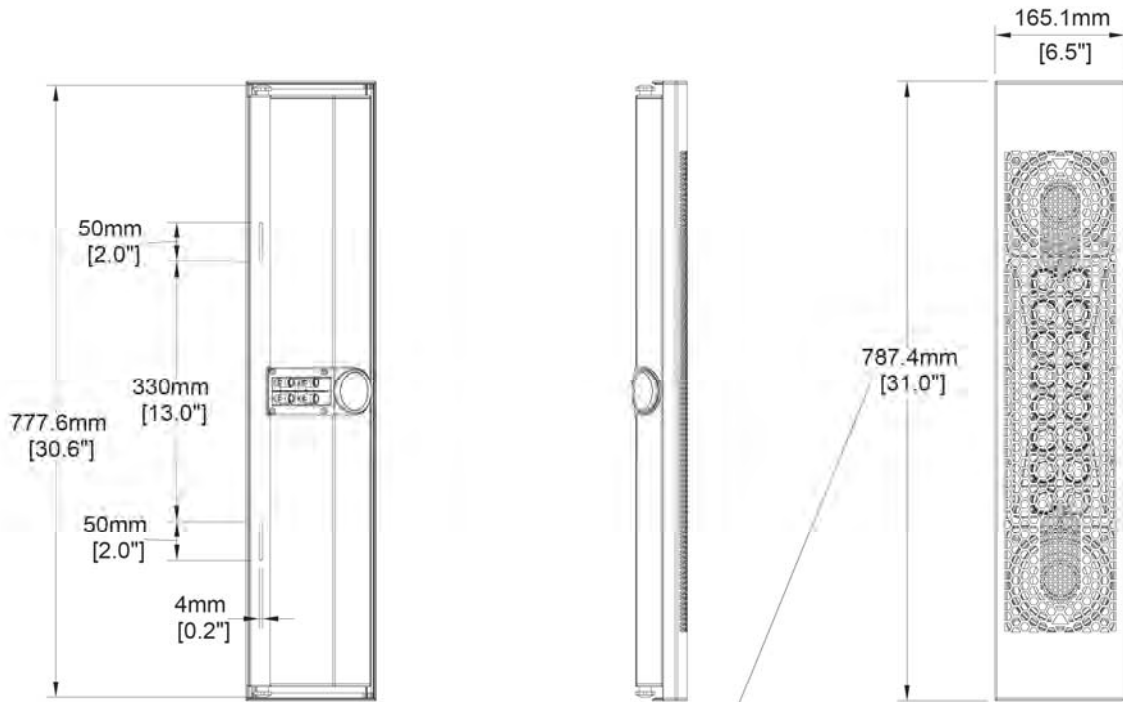
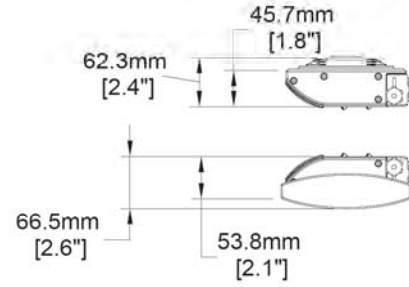
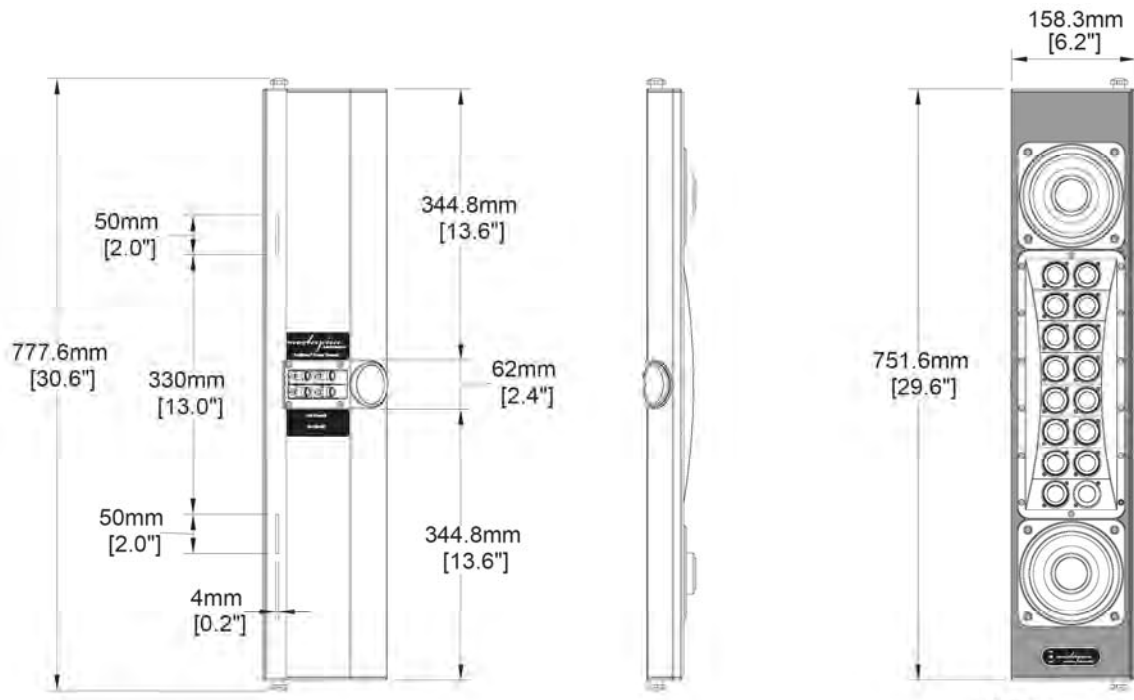

NOTE: MINIMUM GRILLE HEIGHT
762mm [30.0"]

Portrait LCR DualMono

P-LCR-DM

Dimensions:	25.0" x 6.3" x 2.4", HWD Overall 25.4" x 6.5" x 2.6", HWD w/ Minimum Grille Mounting Depth 2.1" ≤ (TV + Thin UMB + Wall Mount) For use with FPTV's 46" or larger: H ≥ 25.4", D 0.28" - 4.4"
Driver Complement:	2. 4½" Kevlar , Long Throw, Inverted Magnet, Midrange/Woofers 2. XT25 Super Audio Tweeters, 15° Swivel Mount 1. 25mm Stage Tweeter
Cabinet / Finish:	Extruded Aluminum / Black Anodized; (Grille Cloth available in Black or Light Grey)
Frequency Response:	80 Hz – 40 kHz ± 3 dB
Recommended Power:	75 - 150 Watts
Nominal Impedance:	6 Ω
Sensitivity:	87dB @ 2.83 Volts, 1 Meter
Enclosure Type:	Acoustic Suspension
System Weight:	25 lbs. (11 kg.) incl. Speakers, Mounting Hardware & Grilles

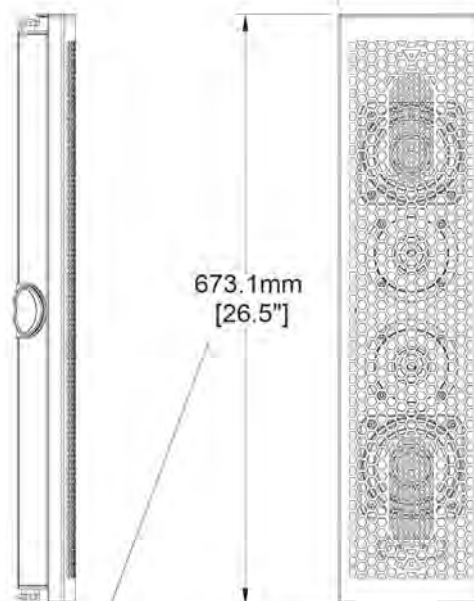
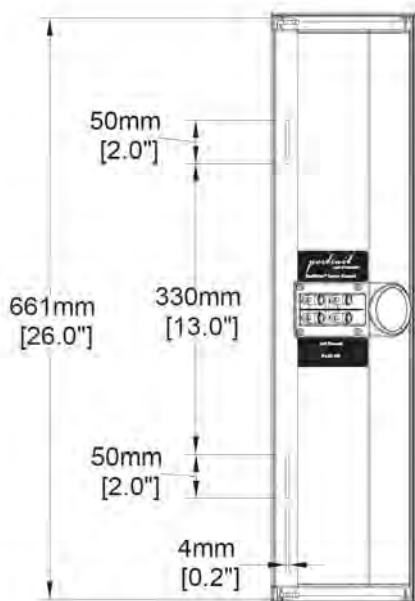
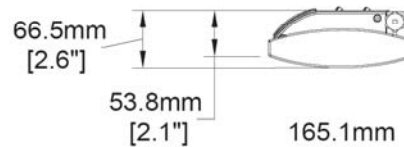
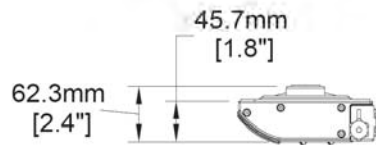
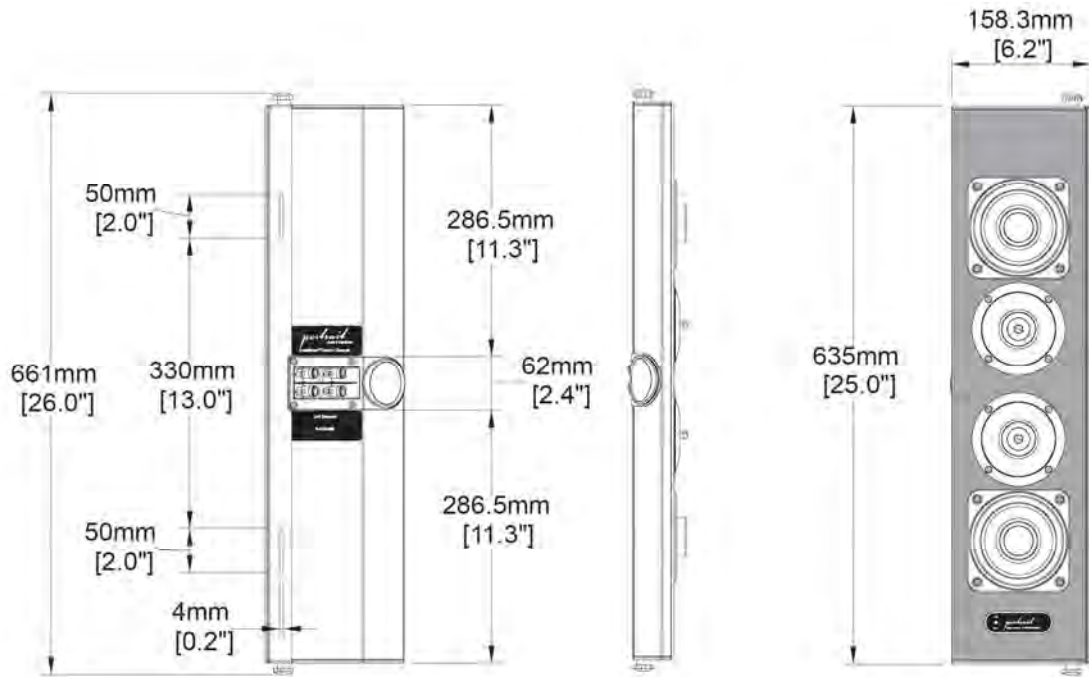

NOTE: MINIMUM GRILLE HEIGHT
645.2mm [25.4"]

Sketch LCR DualMono

S-LCR-DM

Dimensions:	25.0" x 6.3" x 2.4", HWD Overall 25.4" x 6.5" x 2.6", HWD w/ Minimum Grille Mounting Depth 2.1" ≤ (TV + Thin UMB + Wall Mount) For use with FPTV's 46" or larger: H ≥ 25.4", D 0.28" - 4.4"
Driver Complement:	2. 4½" Polypropylene, Long Throw, Inverted Magnet, Midrange / Woofers 2. 27mm Super Audio Tweeters 1. 25mm Silk Dome Stage Tweeter
Cabinet / Finish:	Black Anodized Aluminum; (Grille Cloth available in Black or Light Grey)
Frequency Response:	80 Hz – 40 kHz ± 3 dB
Recommended Power:	75 - 150 Watts
Nominal Impedance:	6 Ω
Sensitivity:	87dB @ 2.83 Volts, 1 Meter
Enclosure Type:	Acoustic Suspension
System Weight:	25 lbs. (11 kg.) incl. Speakers, Mounting Hardware & Grilles

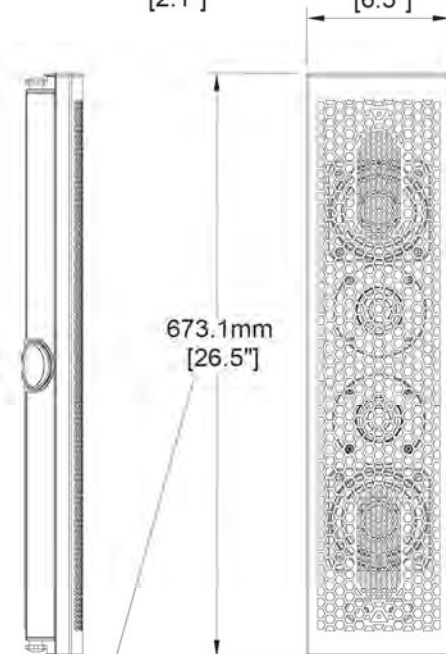
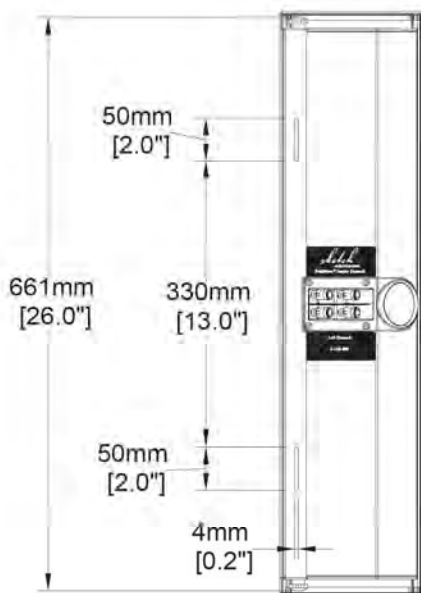
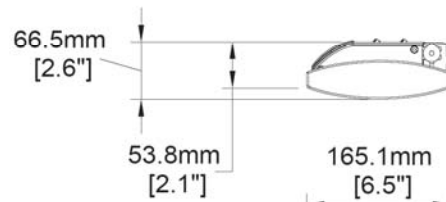
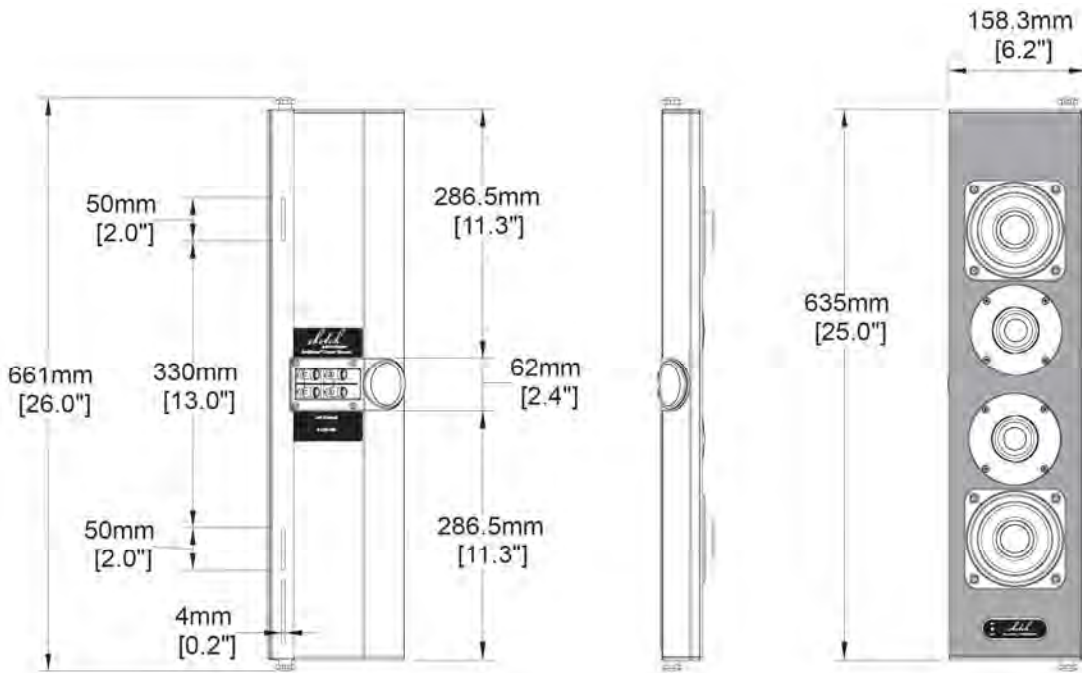

NOTE: MINIMUM GRILLE HEIGHT
645.2mm [25.4"]

LCR DM GRILLE

Cloth Colors: Black and Light Grey
Dimensions: (FPTV Height) x 6.5" x 1.0", HWD
Minimum Height 25.4" for Sketch LCR-DM
Minimum Height 25.4" for Portrait LCR-DM
Minimum Height 30.0" for Masterpiece LCR-DM

THIN UMB

Dimensions: 2.5" x 40.5" x 0.28", HWD w/ Arms Retracted
2.5" x 68.5" x 0.28", HWD w/ Arms Fully Extended

REPACK DIAGRAM

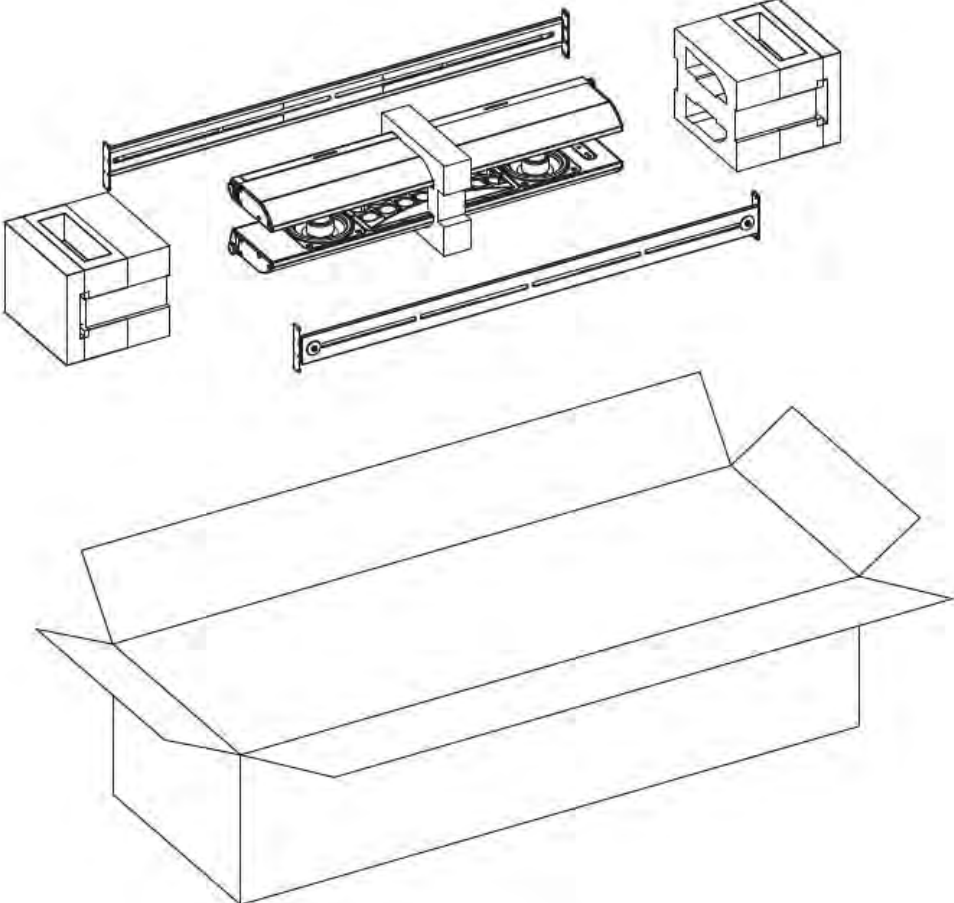

LIMITED WARRANTY

This warranty remains in effect for five years from the date of purchase for speaker products and one year for electronic products.

THIS WARRANTY PROTECTS THE ORIGINAL OWNER PROVIDING THAT THE PRODUCT HAS BEEN PURCHASED FROM AN AUTHORIZED ARTISON DEALER IN THE UNITED STATES. THE ORIGINAL BILL OF SALE MUST BE PRESENTED WHENEVER WARRANTY SERVICE IS REQUIRED. FOR WARRANTY SERVICE OUTSIDE THE UNITED STATES, CONTACT THE AUTHORIZED ARTISON DISTRIBUTOR IN THE COUNTRY WHERE THE PRODUCT WAS PURCHASED.

Except as specified below, this warranty covers all defects in material and workmanship. The following are not covered: Damage caused by accident, misuse, abuse, product modification or neglect, damage occurring during shipment, damage from failure to follow instructions contained in the Owners Manual, damage resulting from the performance of repairs by someone not authorized by Artison, or any claims based on misrepresentations by the seller. This warranty does not cover incidental or consequential damages. It does not cover the cost of removing or reinstalling the unit. **THIS WARRANTY IS VOID IF THE SERIAL NUMBER HAS BEEN REMOVED OR DEFACED, OR IS PURCHASED FROM AN UNAUTHORIZED DEALER ON THE INTERNET (WORLD WIDE WEB), MAIL ORDER, 800, 888, 877 TELEPHONE NUMBERS OR THROUGH A CATALOG.**

This warranty gives you specific legal rights. You may also have other rights, which vary from state to state. Some states do not allow the exclusion or limitation of incidental or consequential damages or limitations on how long an implied warranty lasts, so the above may not apply to you.

Please make note of the following information and retain for your record.

Product Name _____ Model Number _____

Store Name _____ Purchase Price _____

HOW TO OBTAIN SERVICE

Please call us at (775) 833-4344, or write to: ARTISON (Attention: Customer Service Department), 774 Mays Blvd., Suite 10-183, Incline Village, NV 89451.

We will promptly advise you of what action to take. We may direct you to an authorized Artison Service Center or ask you to send your speaker to the factory for repair. You will need to present the original bill of sale to establish the date of purchase. **PLEASE DO NOT SHIP YOUR ARTISON PRODUCT TO THE FACTORY FOR REPAIR WITHOUT PRIOR AUTHORIZATION. PLEASE DO NOT RETURN PRODUCT TO THE ABOVE ADDRESS, IT IS NOT A SERVICE LOCATION.** You are responsible for transporting your product for repair and for payment of any initial shipping charges. However, we will pay the return shipping charges if the repairs are covered under warranty.